

**TYPE 4B-E-A**

#03-09 237 SQM  
 #05-09 2551 SQ FT  
 #07-09  
 #09-09

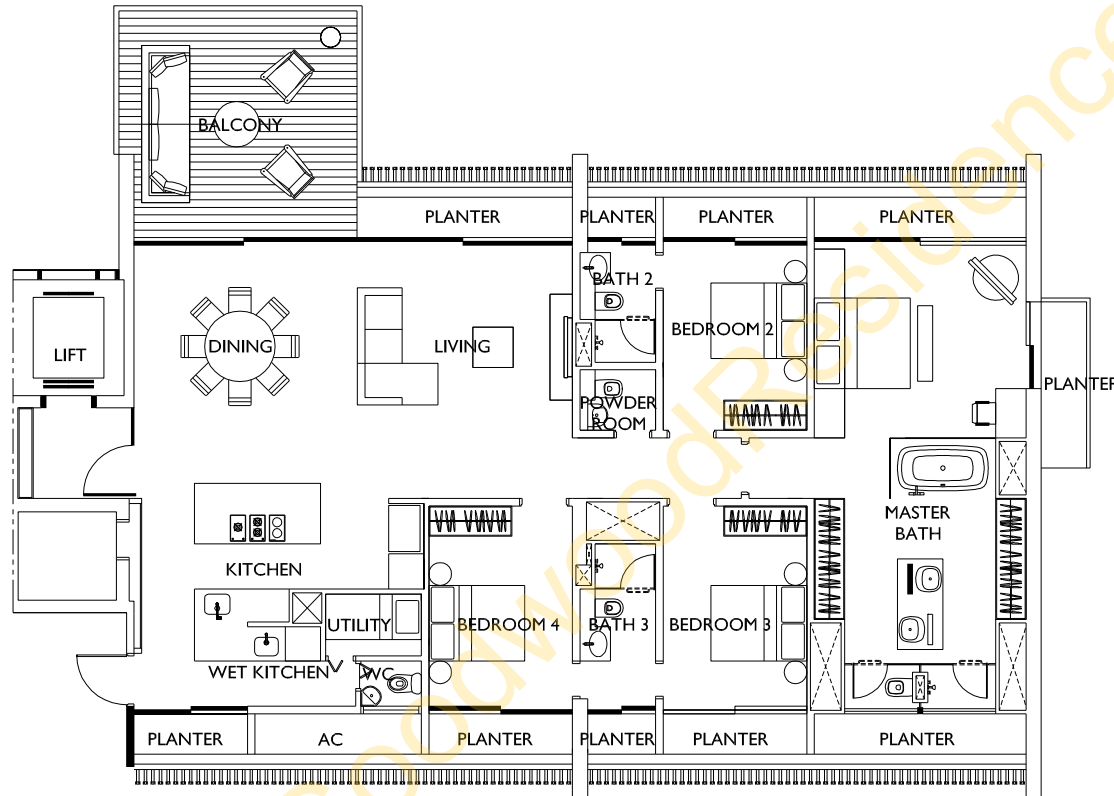

BUILDING PLAN REF. : A1576-00143-2006-BP01  
 APPROVAL REF. : ES20070907-58734  
 APPROVAL DATE : 19 SEP 2007

BUILDING PLAN REF. : A1576-00143-2006-BP02  
 APPROVAL REF. : ES20110913-65054  
 APPROVAL DATE : 22 SEP 2011

BUILDING PLAN REF. : A1576-00143-2006-BP03  
 APPROVAL REF. : ES20120920-65922  
 APPROVAL DATE : 28 SEP 2012

